



BULL SHARK | Class 200' Liftboat

HOME PORT: NEW ORLEANS, LA

allcoastllc.com/specsheets

Overview

LEG

Leg Length	200 ft
Leg Diameter (Od)	66 in
Leg Tower Height	15 ft

HULL

Length (Overall)	105 ft
Length (Barge Only)	102 ft
Beam (Overall)	78 ft
Beam (Barge Only)	78 ft
Hull Depth	13 ft

PAD

Length	26 ft
Width	14 ft
Depth	2 ft
Bearing Load	N/A
Design	4-Way Slope

CRANE

	Port	Starboard
--	------	-----------

Load Rating	100 ton	25 ton
Make	Amclyde	Nautilus
Model	20000HD	180BT3-72
Boom Type	Lattice	Telescopic
Boom Length	100 ft	70 ft
Crane Inst. Type	Deck Mount	Deck Mount

PROPULSION

Mains - Make	CAT
Mains - Model	3406
Horsepower	1,095 kw
Bow Thruster Equipped	No
Clutch Make/Reduction	N/A
Consumption/Engine-Full	22.6 gph
Consumption/Engine-Half	16.8 gph

GENERATORS

Generator Engine Make	CAT
Generator Engine Model	3404
Generator Output	105 kw
Consumption/Gen	9.5 gph

DECK

Total Deck Area	5,275 ft ²
Clear Deck Area	2,688 ft ²
Additional Clear Area	1,020
Maximum Deck Load	1,100,000

CAPACITIES

Diesel Fuel	11,298 usg
Lube	250 usg
Hydraulic Oil	2,236 usg
Potable Water	17,126 usg
Watermaker Equipped	No

ELECTRONIC AIDS & COMMUNICATION

Compass	Fully Equipped
Gps/Dgps	Fully Equipped
Radar(s)	Fully Equipped
Fathometer	Fully Equipped
Loudhailer	Fully Equipped
Satellite Phone	Fully Equipped
VHF Radio	Fully Equipped
Single Sideband Radio	Fully Equipped
EPIRB	Fully Equipped
GMDSS	Fully Equipped

PERSONNEL ACCOMMODATIONS

Total Accommodations	41
VIP Accommodations	2
Galley & Dining	Fully Equipped
TV Lounge	Fully Equipped
Laundry Facility	Fully Equipped
Air Condition / Heater	Std Central Units

PERFORMANCE

Estimated Speed	4 knots
Max Sep – Pad to Deck	195 ft
Max Working Water Depth	160 ft
Min Working Water Depth	12 ft

DOCUMENTATION

Class	None
Flag/ Port of Registry	USA / New Orleans, LA
USCG	Inspected
SOLAS	No
Official Number	1070562
IMO	8764690
Call Sign	WDH4790
Year Built	1998
Builder	Conrad Industries
Zero Discharge	Yes
Registered Tonnage	None
International Tonnage	859

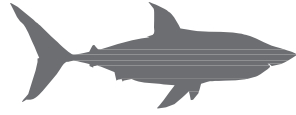

AMCLYDE 100 TON CRANE		
20000HD		
100 FT LATTICE BOOM		
MAXIMUM SAFE WORKING LOAD		
BOOM RADIUS (ft)	ONBOARD LOAD (lbs.)	OFFBOARD LOAD (lbs.)
25	200,000	133,000
30	200,000	127,000
35	165,000	108,000
40	142,000	93,000
45	125,000	81,000
50	110,000	72,000
55	99,000	64,000
60	90,000	58,000
65	82,000	53,000
70	76,000	48,000
75	70,000	45,000
80	65,000	41,000
85	60,000	38,000
90	57,000	36,000
95	53,000	33,000
100	50,000	31,000
105	47,000	29,000
106	46,000	29,000

FAST LINE RATED FOR 12,000 AT ALL RADII



NAUTILUS 25 TON CRANE		
180BT3-72		
70 FT TELESCOPIC BOOM		
MAXIMUM SAFE WORKING LOAD		
29 FT BOOM RETRACTED		
BOOM RADIUS (ft)	ONBOARD LOAD (lbs.)	OFFBOARD LOAD (lbs.)
5	43,200	28,467
10	43,200	28,467
15	43,200	28,467
20	43,200	28,467
25	43,200	28,467
29	43,200	28,467
72 FT BOOM EXTENDED		
BOOM RADIUS (ft)	ONBOARD LOAD (lbs.)	OFFBOARD LOAD (lbs.)
10	16,100	10,400
15	16,100	10,400
20	16,100	10,400
25	16,100	10,400
30	16,100	10,400
35	16,100	10,400
40	16,100	10,400
45	16,100	10,400
50	16,100	10,400
55	15,719	10,146
60	14,161	9,107
65	12,826	8,217
70	11,683	7,455
72	11,247	7,165
FAST LINE RATED FOR 6,483 AT ALL RADII		

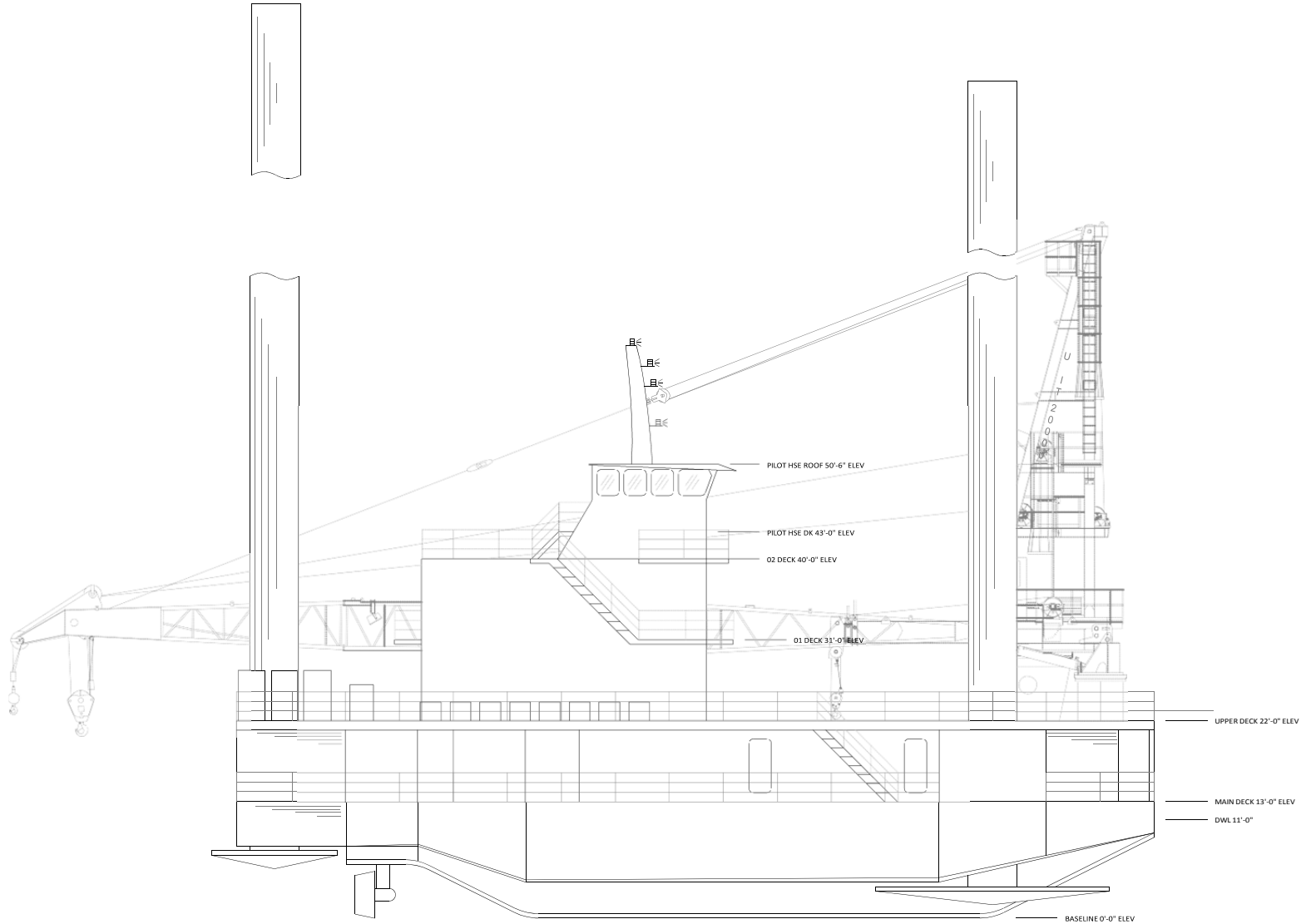



Open Deck Area

Total Deck Area
5,275 Square Feet

Clear Deck Area
2,688 Square Feet

Additional Clear Area
1,020 Square Feet

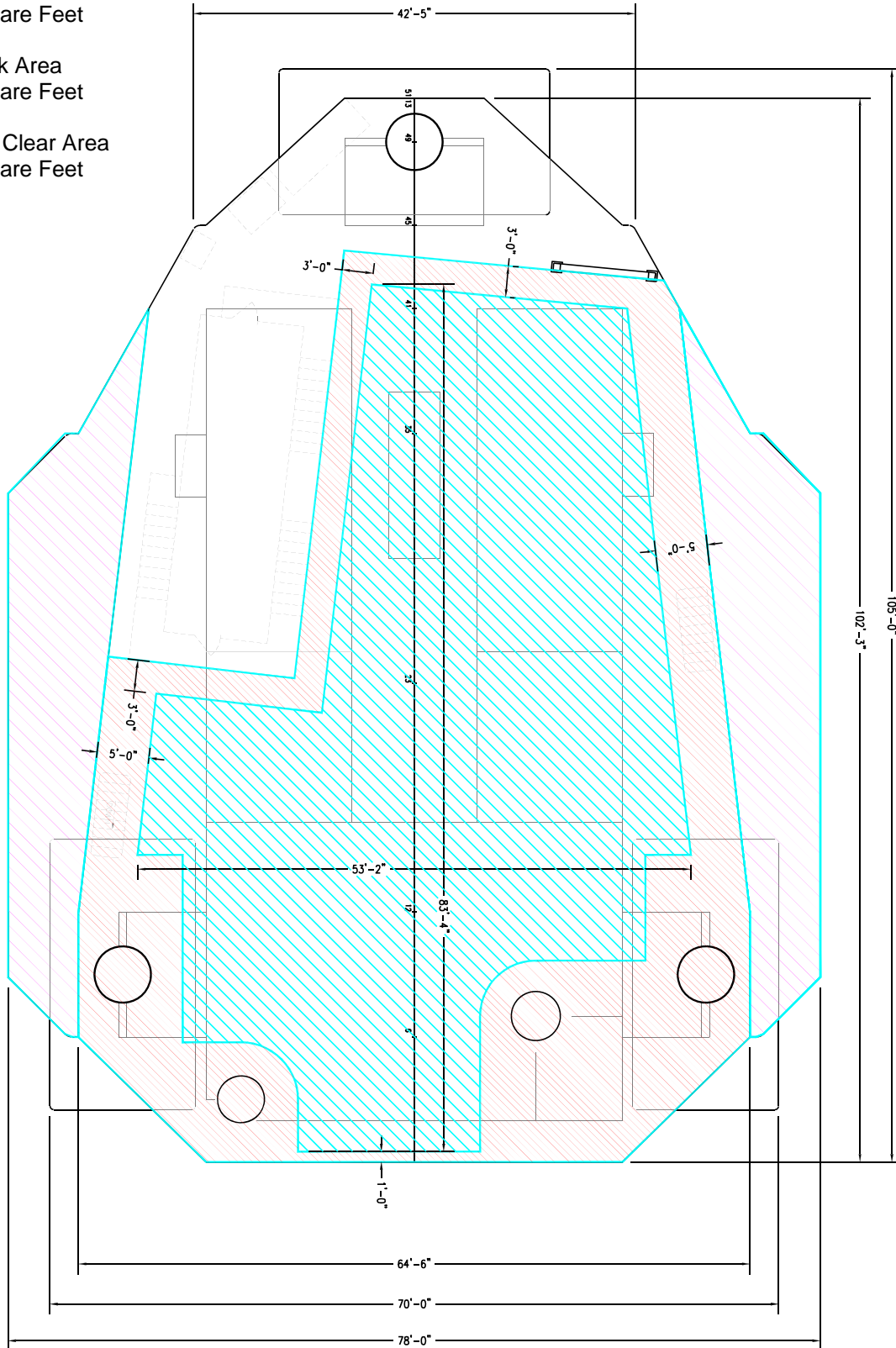



Main Deck Quarters

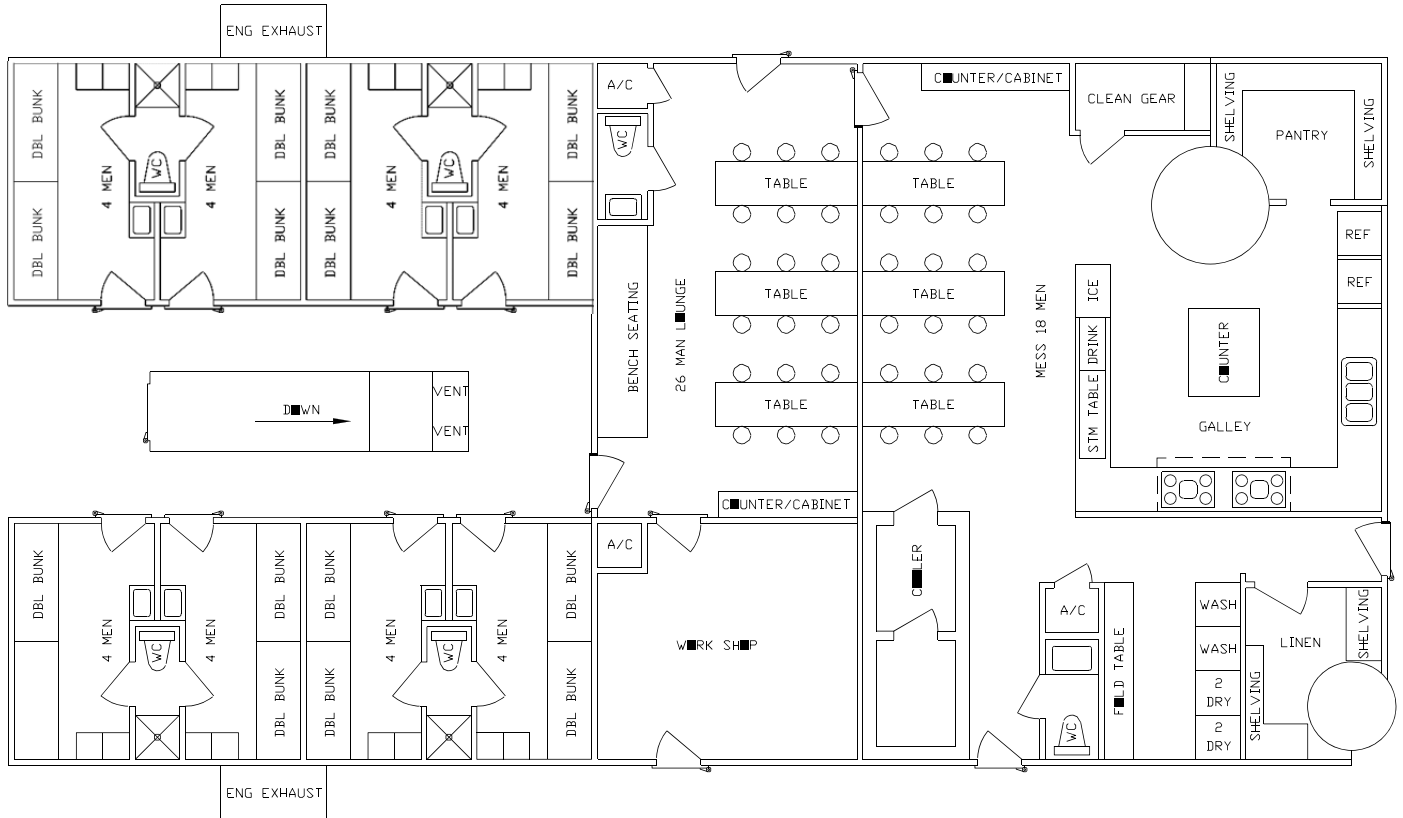

01 Level Quarters

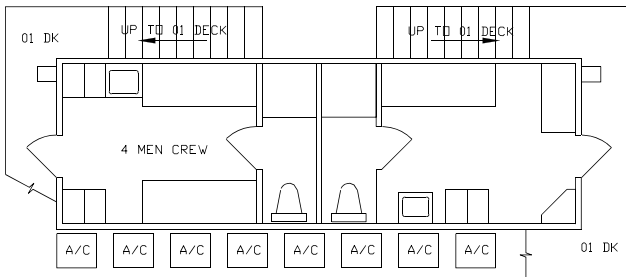

Pilothouse Level

